



INSTRUCTION SHEET

COMMON MOVE ADJUSTMENTS

- i** Before beginning assembly, make sure you have all the necessary parts. These parts must be ordered through your representative or through the Moton Composites customer service. Make sure to have the serial number of your wheelchair to make ordering easier.

Material(s) required: Tool(s) required:

- Complete assembly of a MOVE wheelchair

- 4 mm Allen key
- 5mm Allen key
- 13 mm wrench
- 1 1/32" or 26mm socket
- 5/8" wrench

Move FRONT Seat-to-floor Height

Fork/Position		4" caster			5" caster			6" caster			7" caster			8" caster		
		Stem bolt length			Stem bolt length			Stem bolt length			Stem bolt length			Stem bolt length		
		STD	+1"	+2"	STD	+1"	+2"	STD	+1"	+2"	STD	+1"	+2"	STD	+1"	+2"
4"	P1	12 1/2"	13 1/2"	14 1/2"												
	P2	13"	14"	15"	13 1/2"	14 1/2"	15 1/2"									
5"	P1															
	P2	13"	14"	15"	13 1/2"	14 1/2"	15 1/2"									
	P3	13 1/2"	14 1/2"	15 1/2"	14"	15"	16"	14 1/2"	15 1/2"	16 1/2"						
	P4	14"	15"	16"	14 1/2"	15 1/2"	16 1/2"	15"	16"	17"	15 1/2"	16 1/2"	17 1/2"			
7"	P1							15 1/2"	16 1/2"	17 1/2"	16"	17"	18"			
	P2				15 1/2"	16 1/2"	17 1/2"	16"	17"	18"	16 1/2"	17 1/2"	18 1/2"			
	P3				16"	17"	18"	16 1/2"	17 1/2"	18 1/2"	17"	18"	19"	17 1/2"	18 1/2"	19 1/2"
	P4	16"	17"	18"	16 1/2"	17 1/2"	18 1/2"	17"	18"	19"	17 1/2"	18 1/2"	19 1/2"	18"	19"	20"
	P5	16 1/2"	17 1/2"	18 1/2"	17"	18"	19"	17 1/2"	18 1/2"	19 1/2"	18"	19"	20"	18 1/2"	19 1/2"	20 1/2"

Height available +/- 1/4" (see stem bolt and fork combination at the end of the order form)

Reference : MOVE_Orderform-CAN-6.2_4

Fork and Stem bolt combinations

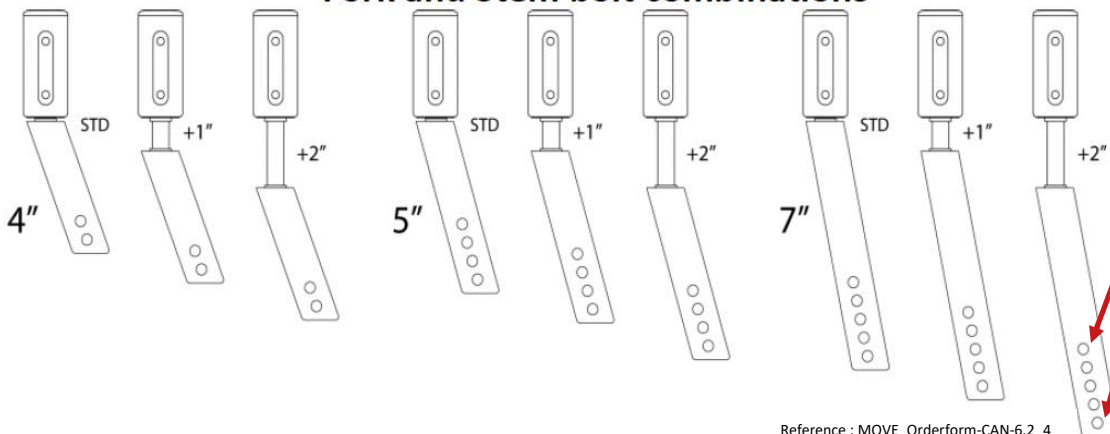

Reference : MOVE_Orderform-CAN-6.2_4



INSTRUCTION SHEET
COMMON MOVE ADJUSTMENTS

ADJUSTING THE CASTER HOUSING: ECCENTRIC INSERT ADJUSTMENTS

Table of Setting Positions Based on Rear Seat Slope

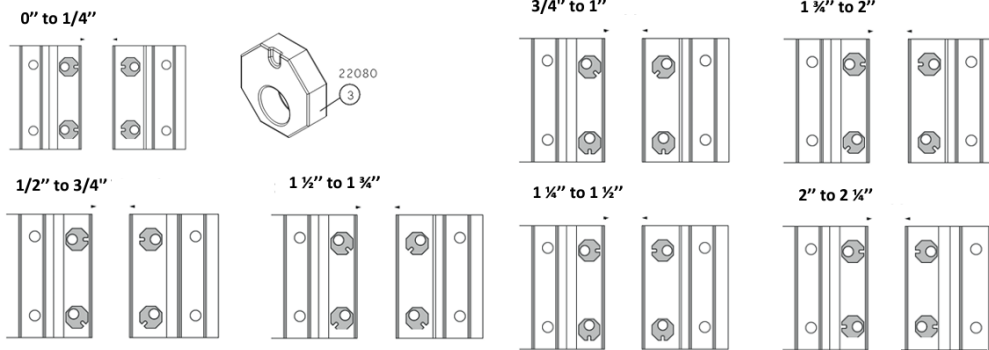

- TOOLS REQUIRED :**
- 4mm Allen key
 - 5mm Allen key
 - 13mm wrench

SEE THE HOW-TO DOCUMENTS AT WWW.MOTIONCOMPOSITES.COM FOR MORE DETAILED ADJUSTMENT INSTRUCTIONS.

SQUARING THE FRONT CASTERS

STEP 1:

- Place the chair on a level, straight work surface.
- Loosen the bolts (#1) on one of the front caster housing (#2) until the inserts (#3) are free to move

STEP 2:

- Refer to the adjustment angle chart on the next page to select the angle that will best align the caster housing with the floor in relation to the desired seat slope.
- The notches on the top and bottom inserts (#3) serve as markers to place the caster housing (#2) at the desired angle

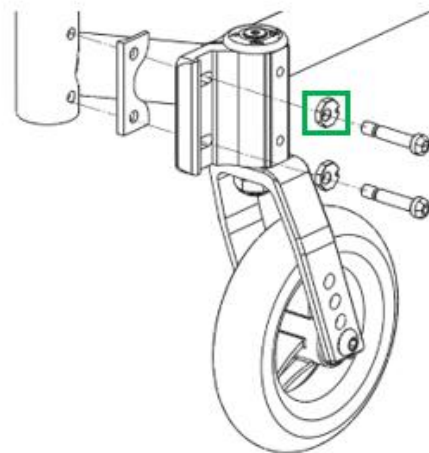

STEP 3:

- Apply medium strength thread locker (blue Loctite) at the end of the threads of the screw.
- Retighten the bolts (#1) and apply a torque:
 - 7 Nm for 40mm long* screws
 - 12 Nm for 35mm long *screws

* Length is measured from the point at which the head sits flat with the surface, to the tip of the threads

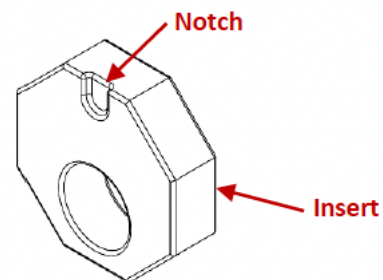

STEP 4:

- Repeat the operation for the other caster housing.



INSTRUCTION SHEET
COMMON MOVE ADJUSTMENTS

AXLE PLATE – SEAT TO FLOOR HEIGHT & CENTER OF GRAVITY ADJUSTMENT

Move REAR Seat-to-floor Height

20" (451)	22" (501)	24" (540)	25" (559)	26" (590)
12" <input type="checkbox"/>	13" <input type="checkbox"/>	14" <input type="checkbox"/>	14 1/2" <input type="checkbox"/>	15" <input type="checkbox"/>
13" <input type="checkbox"/>	14" <input type="checkbox"/>	15" <input type="checkbox"/>	15 1/2" <input type="checkbox"/>	16" <input type="checkbox"/>
14" <input type="checkbox"/>	15" <input type="checkbox"/>	16" <input type="checkbox"/>	16 1/2" <input type="checkbox"/>	17" <input type="checkbox"/>
15" <input type="checkbox"/>	16" <input type="checkbox"/>	17" <input type="checkbox"/>	17 1/2" <input type="checkbox"/>	18" <input type="checkbox"/>
16" <input type="checkbox"/>	17" <input type="checkbox"/>	18" <input type="checkbox"/>	18 1/2" <input type="checkbox"/>	19" <input type="checkbox"/>
17" <input type="checkbox"/>	18" <input type="checkbox"/>	19" <input type="checkbox"/>	19 1/2" <input type="checkbox"/>	20" <input type="checkbox"/>

Note: Tire size, center of gravity setting and seat slope may result in a variation of +/- 1/2" of selected seat to floor height"

Reference : MOVE_Orderform-CAN-6.2_4

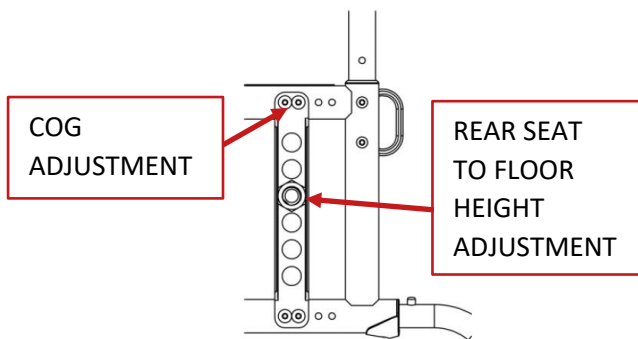

Choose position of rear wheel axle plate:

Measure distance from front of back post to center of axle receiver.

Default setting is at 3/4"

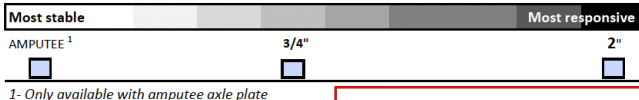

TOOLS REQUIRED :

- 1 1/32" or 26mm Socket
- 5/8" Wrench
- 4mm Allen Key

CHOOSE THE CORRECT ANTI-TIPPER FOR REAR SEAT TO FLOOR HEIGHT

REAR SEAT-TO-FLOOR HEIGHT	BEND	EXTENSION	COMPLETE SET*
12.50 in to 12.75 in	X.small 51513	Short 51517	9001620
13.00 in to 13.50 in	X.small 51513	Long 51518	9001621
13.75 in to 14.25 in	Small 51519	Short 51517	9001614
14.50 in to 15.50 in	Small 51519	Long 51518	9001615
15.75 in to 16.25 in	Medium 51520	Short 51517	9001616
16.50 in to 17.75 in	Medium 51520	Long 51518	9001617
18.00 in to 18.75 in	Large 51521	Short 51517	9001618
19.00+ in	Large 51521	Long 51518	9001619

Reference : Anti-Tippers Chart_ENG

ITEM NO.	PART NO.	DESCRIPTION	QTY.
1	9001620	Anti-Tipper X-Small + Short Extension	1
2	9001621	Anti-Tipper X-Small + Long Extension	1
3	9001614	Anti-Tipper Small + Short Extension	1
4	9001615	Anti-Tipper Small + Long Extension	1
5	9001616	Anti-Tipper Medium + Short Extension	1
6	9001617	Anti-Tipper Medium + Long Extension	1
7	9001618	Anti-Tipper Large + Short Extension	1
8	9001619	Anti-Tipper Large + Long Extension	1

