



INSTRUCTION SHEET

STEM BOLT INSTALLATION AND ADJUSTMENT FOR VELOCE AND APEX

- i** Before the beginning of the installation, make sure to have all needed pieces. The pieces must be ordered by your representative or by the customer service from Motion Composites. Have your serial number on hand to facilitate the order.

Material(s) required:

- Fourche-Assemblage avec tige de fourche (#9003229A_9003231A)

Tool(s) required:

- 4 mm Allen key
- 17 mm wrench

INSTALLATION

**9003229A 9003231A
FORK - ASSEMBLY WITH STEM BOLT**

ITEM NO.	PARTNO	DESCRIPTION	9003229	9003230	9003231
1	0022151A-00	STRESS RELIEF STANDARD STEM BOLT	1	-	-
2	0022143A-00	STRESS RELIEF +0.5 STEM BOLT	-	1	-
3	0022144A-00	STRESS RELIEF +1 STEM BOLT	-	-	1
4	0022520A-00	INTEGRATED BEARING FORK - ASSEMBLY	1	1	1
5	0022152A-00	INTEGRATED BEARING'S FORK CAP	1	1	1
6	0090767A-00	SOCKET CAP SCREW M6x1x14mm L	1	1	1
7	0090991A-00	Thin LOCKNUT M10x1.5	1	1	1

9003229A-00
FORK - ASSY & STD STEM BOLT

9003230A-00
FORK - ASSY & +0.5in STEM BOLT

9003231A-00
FORK - ASSY & +1in STEM BOLT

MAKE SURE TO HAVE YOUR SERIAL NUMBER NEARBY WHEN ORDERING PARTS FOR YOUR MOTION COMPOSITES WHEELCHAIR



INSTRUCTION SHEET

STEM BOLT INSTALLATION AND ADJUSTMENT FOR VELOCE AND APEX

1. Remove the screw holding the stem bolt to the wheelchair on the side of the caster housing using the 4 mm Allen key.

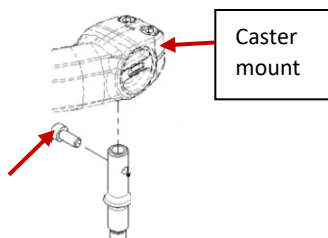

2. Make the following assembly :

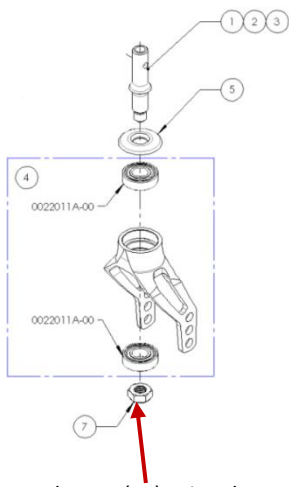

3. Tighten the nut (#7) using the 17 mm wrench.

i To prevent the front wheels from floating, adjust the tension of the nut (#7): when the wheel is off the ground, it should not have a rocking motion (sloshing) when you release it.

i Be careful to not overtighten this nut to not damage the wheel bearings.

4. Reinstall the stem bolt on the caster mount (see step 1).