



INFORMATION SHEET

PARTS LIST FOR ADDING UNOCCUPIED WHEELCHAIR TIE-DOWN ANCHORS



This document lists the parts and hardware needed to add **UNOCCUPIED** wheelchair transport tie-down anchors to a wheelchair that does not have them.



IMPORTANT: This type of tie-down anchor is designed for transporting an **UNOCCUPIED** wheelchair in a vehicle. It is not certified to ANSI/RESNA WC19 or ISO 7176-19 standards. Please refer to the User Manual for information about wheelchair transport safety and options.

Wheelchair model(s)

- CHRONOS
- COBALT 1/2
- HELIO A6/A7/C2/XC2/ K/Kids
- MOVE
- PLATINUM 1/2

Tool(s) and materials required

- Hexagonal key (Allen key): 4 mm
- Torque wrench

INFORMATION

- **Conversion** from a chair **without tie-down anchors** to a chair **with tie-down anchors** requires **four (4) anchors**:
 - **Two (2) identical anchors** installed on **both front wheel caster housings**. These include:
 - Two (2) identical anchor rings
 - Two (2) identical screws longer than the original ones per caster housing for a total of four (4) screws per wheelchair
 - These parts are the same, **regardless of the type of caster housing**: with a clamp system or with a multi-position insert system (see table on the next page)

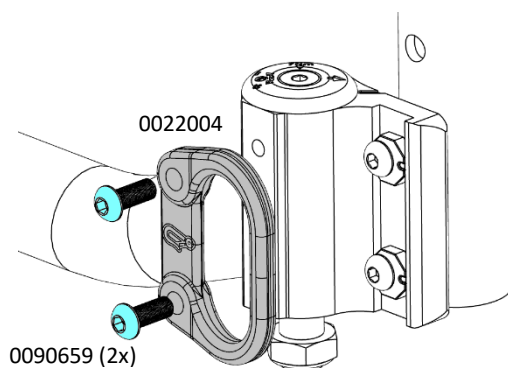

Multi-position insert squaring system

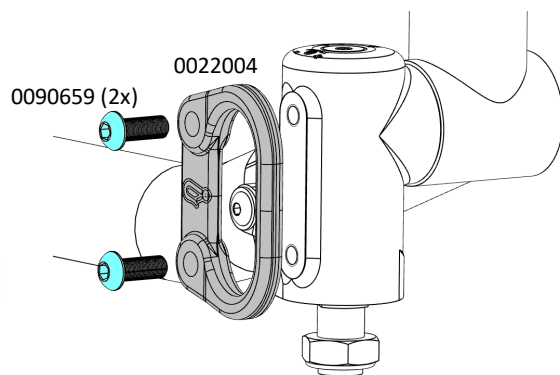

Squaring system clamp system

- **Two (2) tie-down anchors at the rear of the frame.** Anchor and required hardware will vary depending on the backrest or armrest configuration and may include:
 - Longer screws (always)
 - Spacers or washers (depending on the configuration)
- The **table on the next page** lists **all the parts required** for the **front and rear tie-down anchors** depending on the **configuration** of the **wheelchair**



INFORMATION SHEET

PARTS LIST FOR ADDING UNOCCUPIED WHEELCHAIR TIE-DOWN ANCHORS

PARTS LIST FOR ADDING TIE-DOWN ANCHORS ACCORDING TO THE CONFIGURATION OF THE CHAIR

Without armrests or with T-type or flip up armrests or side guards or mudguards

Qty	Part number	Description
4	0022004	Front and rear anchor rings
4	0090659	Front wheel caster housing screws
4	0032066	Double covered washers for rear anchor rings
4	0090670	Screws for back canes, rear anchor rings

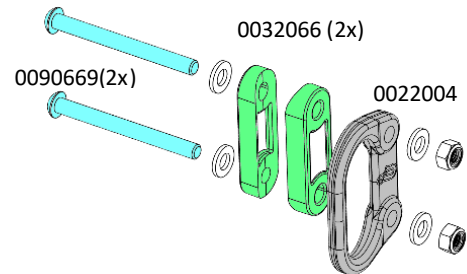

With swing away armrests

4	0022004	Front and rear anchor rings
4	0090659	Front wheel caster housing screws
4	0090669	Screws for back canes, rear anchor rings

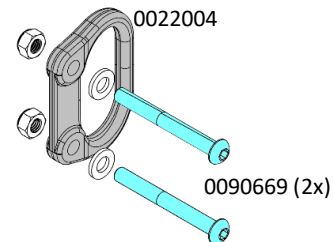

With flip back armrests

4	0022004	Front and rear anchor rings
4	0090659	Front wheel caster housing screws
2	0032066	Double covered washers for rear anchor rings
2	0090670	Screw (short) for back cane, rear anchor rings
2	0090982	Screw (long) for back cane, rear anchor rings

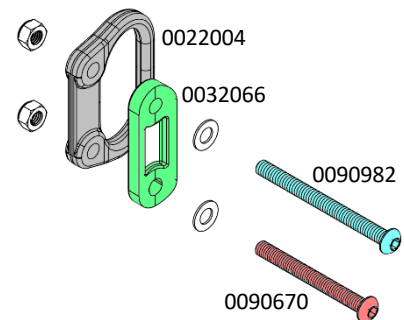

With depth-adjustable backrest

1	0022004	Anchor rings for front wheel caster housing
4	0090659	Front wheel caster housing screws
8	0099560	Back cane anchor washers
4	0090669	Screws for back cane, rear anchor rings
2	0022076	Curved anchor rings

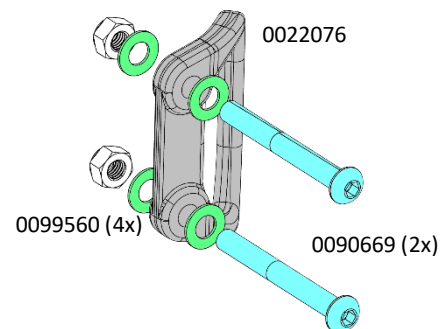



INFORMATION SHEET

PARTS LIST FOR ADDING UNOCCUPIED WHEELCHAIR TIE-DOWN ANCHORS

ASSEMBLING THE TIE-DOWN ANCHORS

- To assemble the tie-down anchors, consult or download the wheelchair **parts manual** available online at www.motioncomposites.com:
 - Select language
 - Click on the "Tools and Forms" button at the top right
 - Click on the "View the Parts Manuals" button in the center of the page
 - Click on the chair model button
- **Tie-down anchor for the front wheel casters:**
 - Assemble as shown on **page 1** of this document
 - Tightening torque to be applied: **7 Nm**
- **Tie-down anchor at the back of the frame:**
 - In the "Backrests Catalog" section, locate the "Back cane Hardware" subsection of your configuration and go to the page indicated
 - From this page, find the "With tie-down" page
 - Assemble according to the drawing (see **example** below)
 - **Tighten the screws firmly.** No special torque required
 - **CAUTION:** If the wheelchair is equipped with **flip back armrests** (example shown below), the tightening must not restrict or prevent the armrests from pivoting

